

Competence in Waste to Energy



Oschatz Power is a leading supplier of plants for the thermal utilization of gaseous, liquid and solid waste materials. In the “Waste to Energy” segment, Oschatz Power offers small and medium-sized plants for fuel volumes of 30,000 to 100,000 t/a (calorific value range: 8 - 23 MJ/kg). All power plants are delivered on a turnkey base.

Fuel spectrum

- Residual materials from waste processing (RDF)
- Pulper rejects and short fiber residues (pulper pulp)
- Commercial waste, biomass, waste wood, etc.

Technologies

- Stationary (bubbling) fluidized bed
- Grate firing (air and water cooled)
- High-pressure steam-generator from 15 to 50 MWth
- Steam turbine set incl. generator, cooler and BoP



Rising prices for fossil fuel in combination with higher CO₂ costs are leading to a new awareness in the energy sector. The thermal utilization of production residues and waste is gaining a completely new and sustainable dimension.

We take care of all process steps - from planning to commissioning as well as the maintenance of the plant:

- Support in project development (FEED, concept development, budget offers)
- Basic and detail engineering
- Process engineering and project management
- Procurement, production monitoring, installation
- Construction site supervision, commissioning, start-up, instruction and training
- Service, spare parts and maintenance

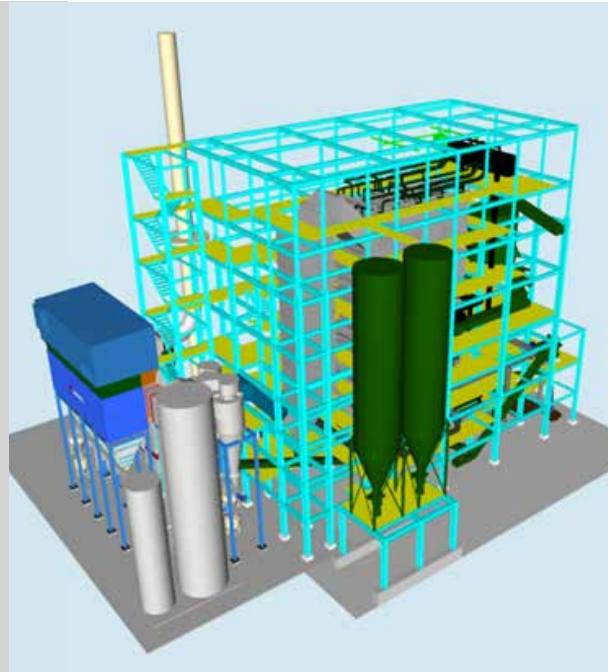

References for residual materials from waste processing (RDF, EBS, SRF)



Hagenow/DE, 410°C, 34t/h, 46 barg



Rudolstadt/DE, 420°C, 33t/h, 38 barg



Andernach/DE, 525°C, 65th, 70 barg

References production waste: paper rejects and short fiber residues (pulper pulp)



Giershagen/DE, 420°C, 33t/h, 38 barg



Mayen/DE, 405°C, 15t/h, 32 barg



Crescentino/IT, 480°C, 50t/h, 65 barg

Oschatz Power GmbH

Limbecker Platz 1 | 45127 Essen | Germany
 Tel.: 0049 (0) 201 18 02-0 | info@oschatz.com | www.oschatz.com